

# ROVECONCEPTS

kaye COLLECTION

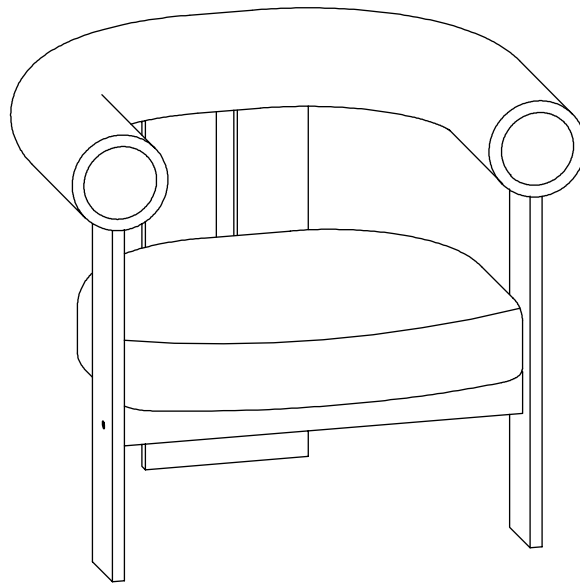

## TOLA OUTDOOR LOUNGE CHAIR ASSEMBLY INSTRUCTIONS

# HARDWARE



**A**

x14  
1/4 \* 15

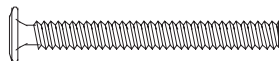

**B**

x2  
1/4 \* 90



**C**

x2  
1/4 \* Ø10 \* 13



**D**

x1  
K4

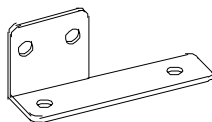

**E**

x1

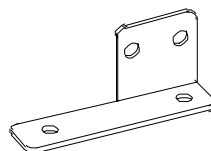

**F**

x1

# STEP 1

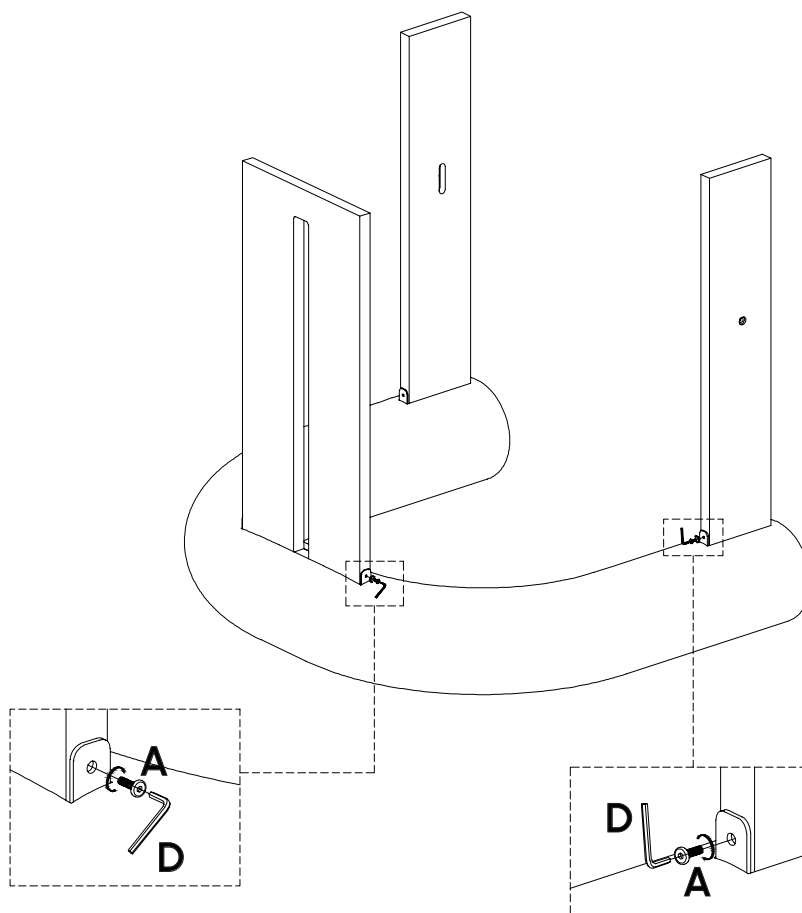

# STEP 2

ROVECONCEPTS

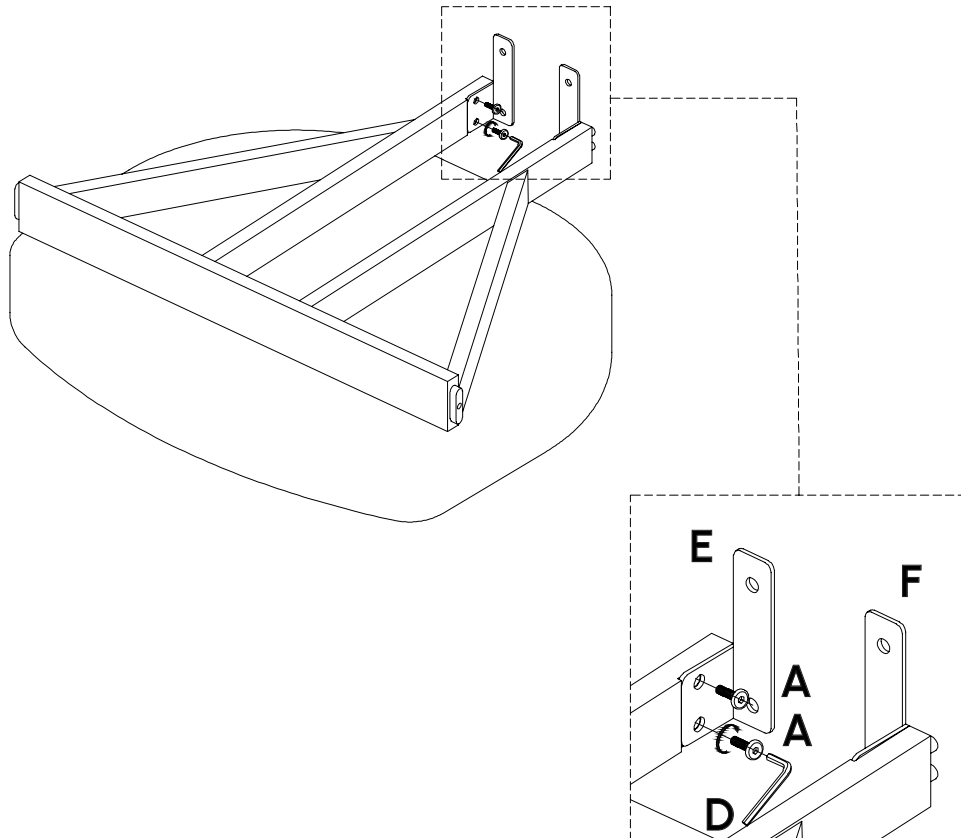

# STEP 3

ROVECONCEPTS

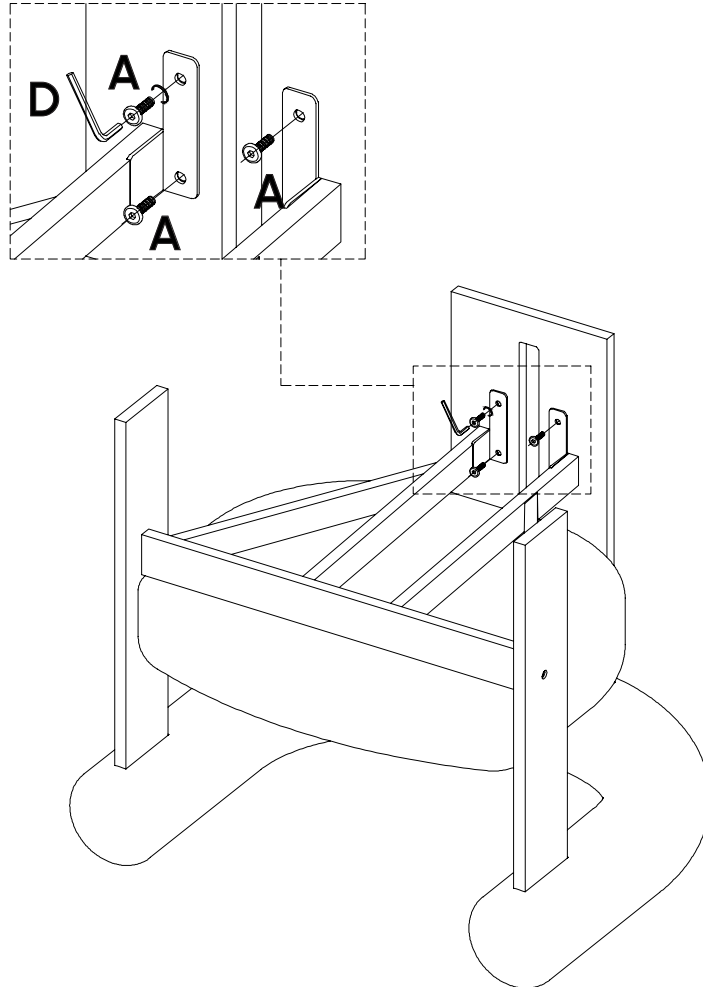

# STEP 4

The nut (C) needs to be turned and facing (B) to tighten the screws.

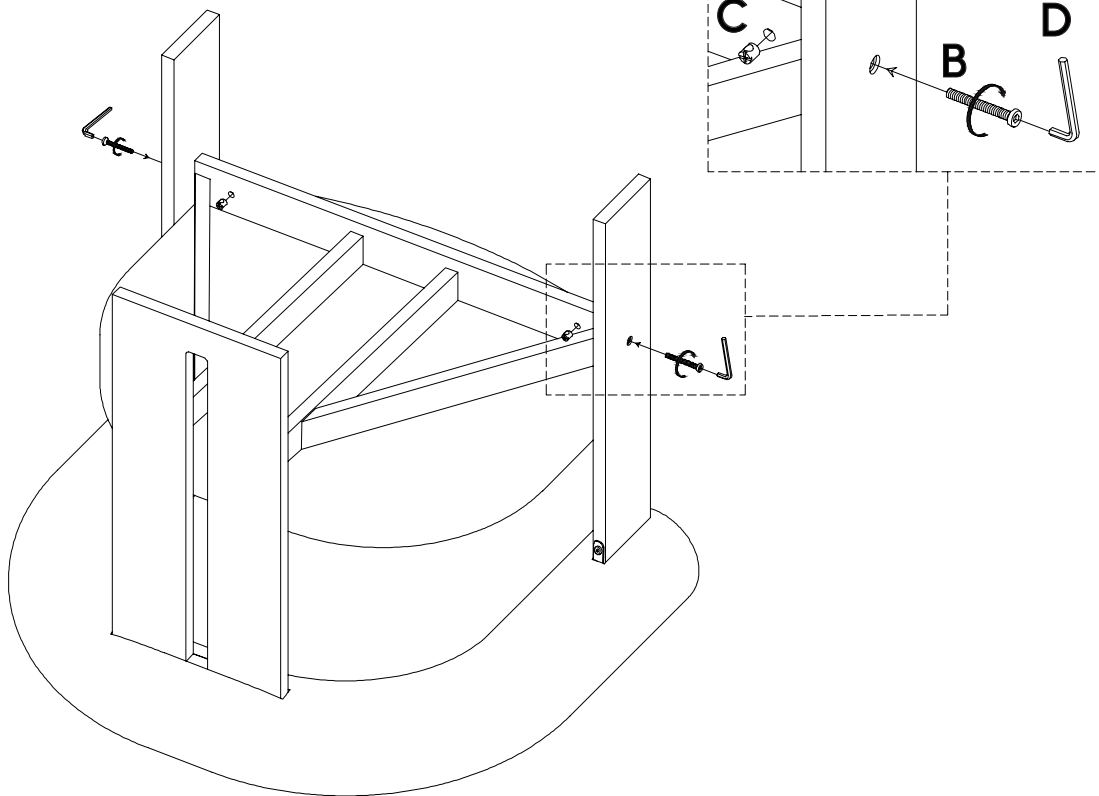

# STEP 5

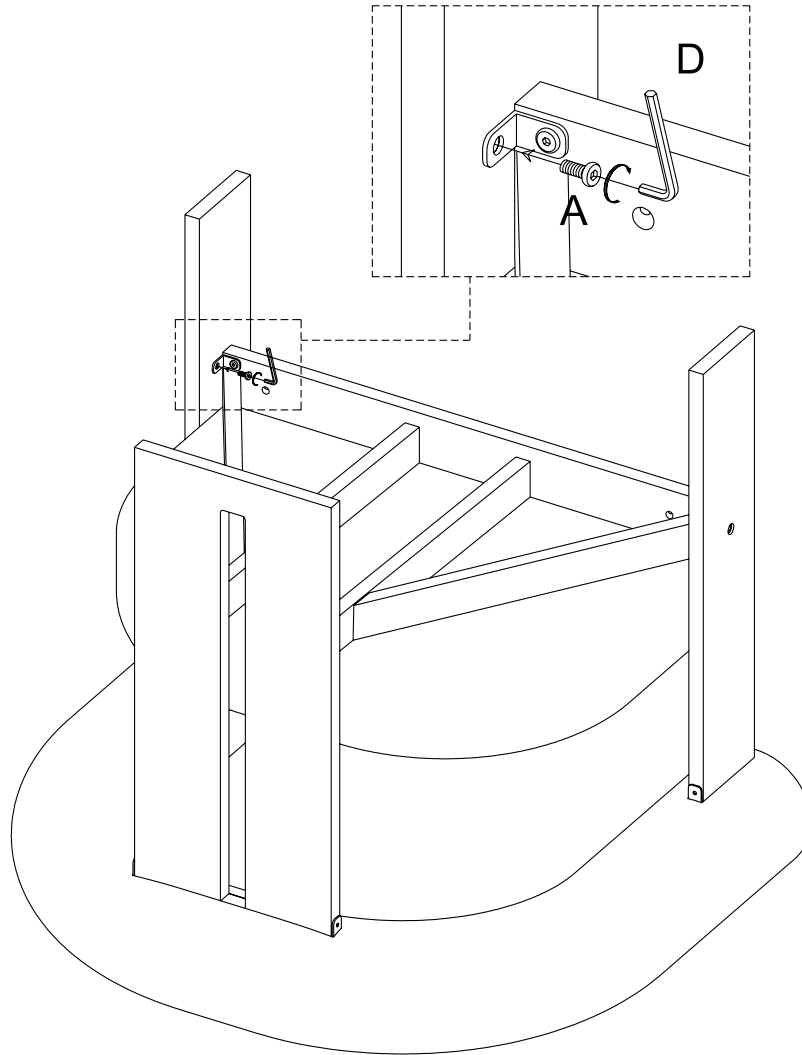

# STEP 5

